

The C365C42H communicating touch thermostats connect to a Wiring Hub installed at the equipment using a 4-wire thermostat cable. When used with the WH42H wiring hub, the thermostat can control heating and cooling, the airflow to the sleeping and living areas to provide a uniformly comfortable home in all seasons, fresh air control, humidity control, whole house fan or economizer control.

The Wiring Hub can use either wired or wireless temperature sensors making them easy to install in replacement installations.



Pat. Pending



Features

- Automatically adjusts airflow to keep the sleeping and living area temperatures to within 2°F.
- Reduces energy usage by 30% at night by directing 30% more airflow to the sleeping area and 30% less airflow to the unoccupied living area.
- Uses the sleeping area temperature sensors at night to control heating and cooling calls.
- Uses wired or wireless, battery powered temperature sensors.
- Manual or automatic airflow control.
- No bypass required. Airflow is maintained at rated CFM.
- About half the cost of a zoning system. Eliminates installing a zoning panel, 24VAC transformer and electrical box, discharge air temperature sensor and adjusting bypass dampers. Only 9 to 11 wires compared to 25 to 27 for zoning.
- Easy plug and play upgrade to the WiFi thermostat. Plugs onto the same subbase.

Specifications

Compatible Equipment

Gas/electric, 2H/2C.
Heat pump, 2H/2C/1Aux.

Thermostat Modes

Schedule, Hold or Vacant.

System Modes

Heating, Cooling, Auto or Off. Heat pumps with auxiliary heating have Em Heat mode.

WHF Control (WH42H Wiring Hub)

The ECool mode controls a WHF or Economizer using temperature or a built-in 1 to 8-hour timer.

Fresh Air (WH42H Wiring Hub)

Intelligent control of fresh air per ASHRAE 62.2 with temperature limits for inhibiting fresh air in severe weather.

Humidifier (WH42H Wiring Hub)

Controls a humidifier.

DeHumidification (WH42H Hub)

Controls dehumidification using the DSBK terminal that forces lower fan speed in cooling to remove moisture.

Fan Modes

Auto or Continuous(On).

Schedules per Day

Morning, Day, Evening and Night.

Schedules Format

5/2 day format.

Temperature Override

Overrides scheduled temperature for 3 hours.

Airflow Modes

Automatic or manual.

Nighttime Airflow Option

Directs 30% more airflow to the sleeping area and uses the sleeping area temperature to control heating and cooling.

Airflow Override

Overrides automatic airflow for three hours to direct more airflow upstairs or downstairs for special occasions.

LCD with Touch

Large FSTN display with wide viewing angle with resistive touch panel.

Power

Uses equipment 24VAC power with two AA batteries for backup.

Optional WiFi Thermostat and App

Model C365C42HWF WiFi thermostat plugs onto same subbase with no wiring changes.

Mechanical

4.68w x 4.30h x 1.10d inches.

C365C42H or C365C42HWF with WH42H with Wired Sensors

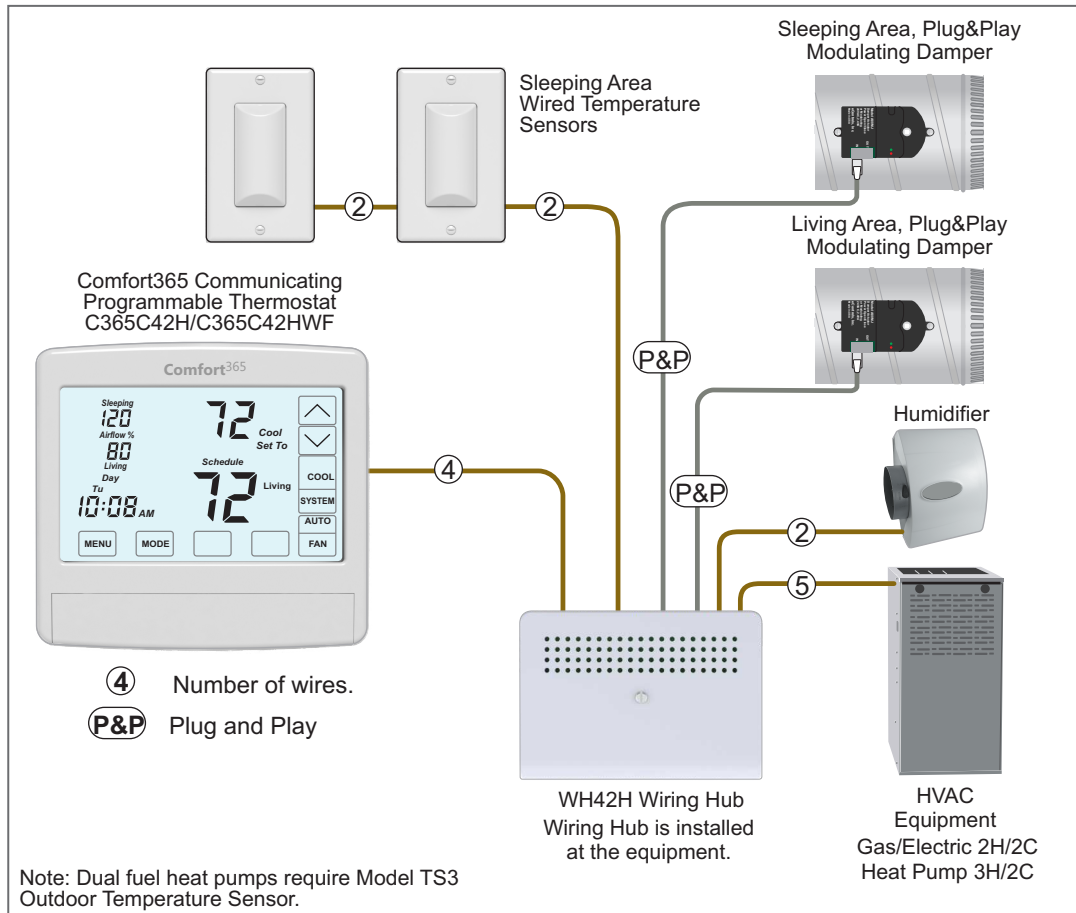

Comfort365 Thermostats

Model C365C42H
Model C365C42HWF
With WiFi

Temperature Sensors

Model TS510W
For single sleeping area sensor installations
Model TS520W
For dual sleeping area sensor installations

Wiring Hub

Model WH42H

Dampers

Model R80CJ-XX
Plug&Play
Modulating Damper
XX is 6 to 20-inch diameter

C365C42H or C365C42HWF with WH42H with Wireless Sensors

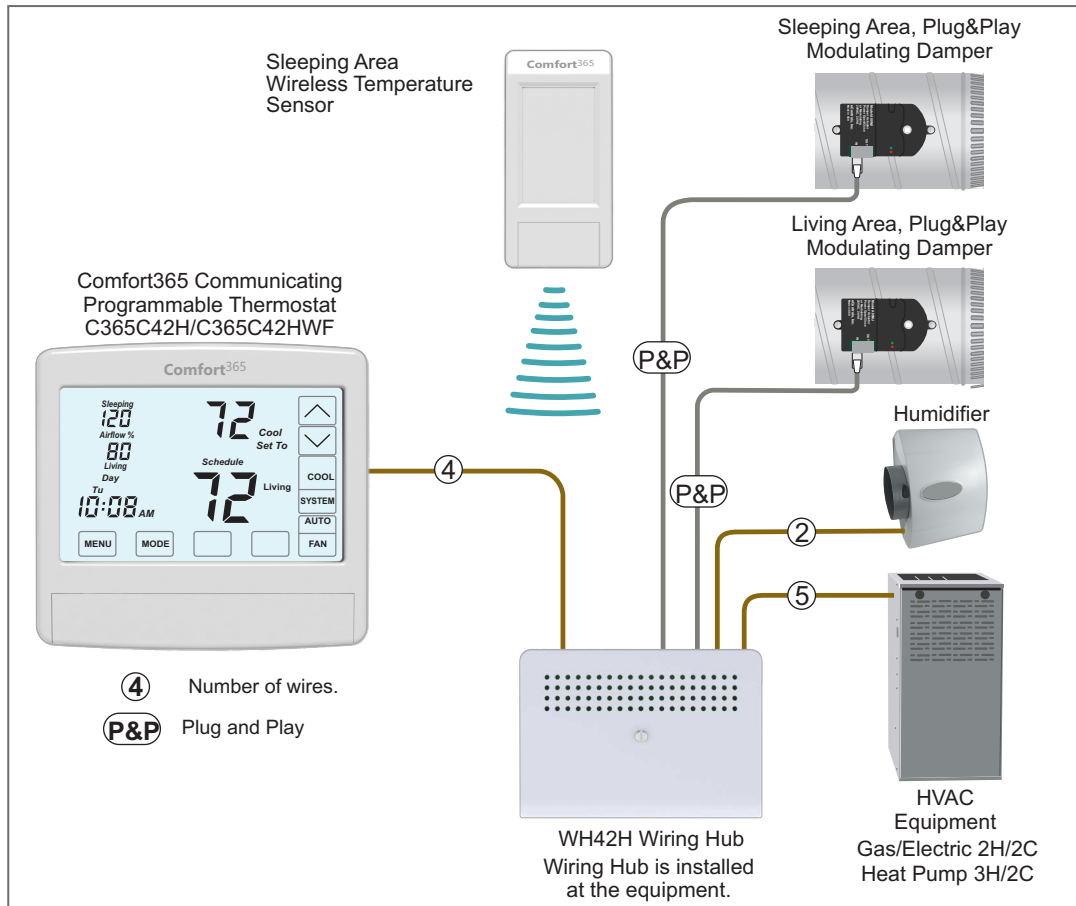

Comfort365 Thermostats

Model C365C42H
Model C365C42HWF
With WiFi

Temperature Sensors

Model TS5WL
For single or dual sleeping area sensor installations
Model ELR1
eLink Plugin Radio required with wireless sensors

Wiring Hub

Model WH42H

Dampers

Model R80CJ-XX
Plug&Play
Modulating Damper
XX is 6 to 20-inch diameter

C365C42H or C365C42HWF with WH42H with Wired Sensors

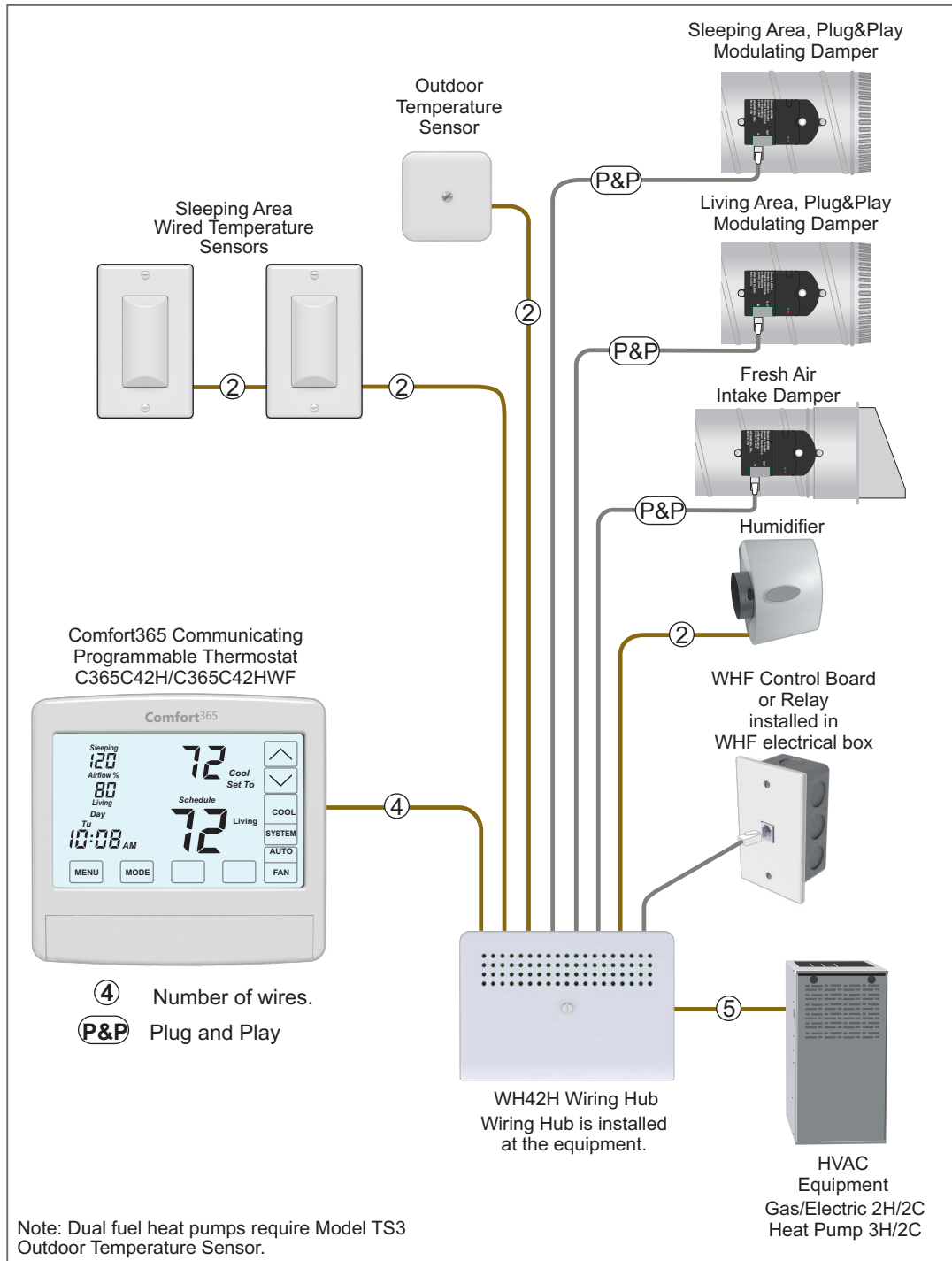

Comfort365 Thermostats

Model C365C42H
Model C365C42HWF
With WiFi

Temperature Sensors

Model TS510W
For single sleeping area sensor installations
Model TS520W
For dual sleeping area sensor installations
Model TS3
Outdoor temperature sensor

Wiring Hub

Model WH42H
For multi-stage G/E or HP

Airflow Dampers

Model R80CJ-XX
Plug&Play
Modulating Damper
XX is 6 to 20-inch diameter

Fresh Air Damper

Model R80ZJ-XX
Plug&Play
Open/Close Damper
XX is 6 to 20-inch diameter

WHF Control Board

Model FC2J
Plug&Play
Controls 1 or 2-Speed PSC or PWM control of ECM

C365C42H or C365C42HWF with WH42H with Wireless Sensors

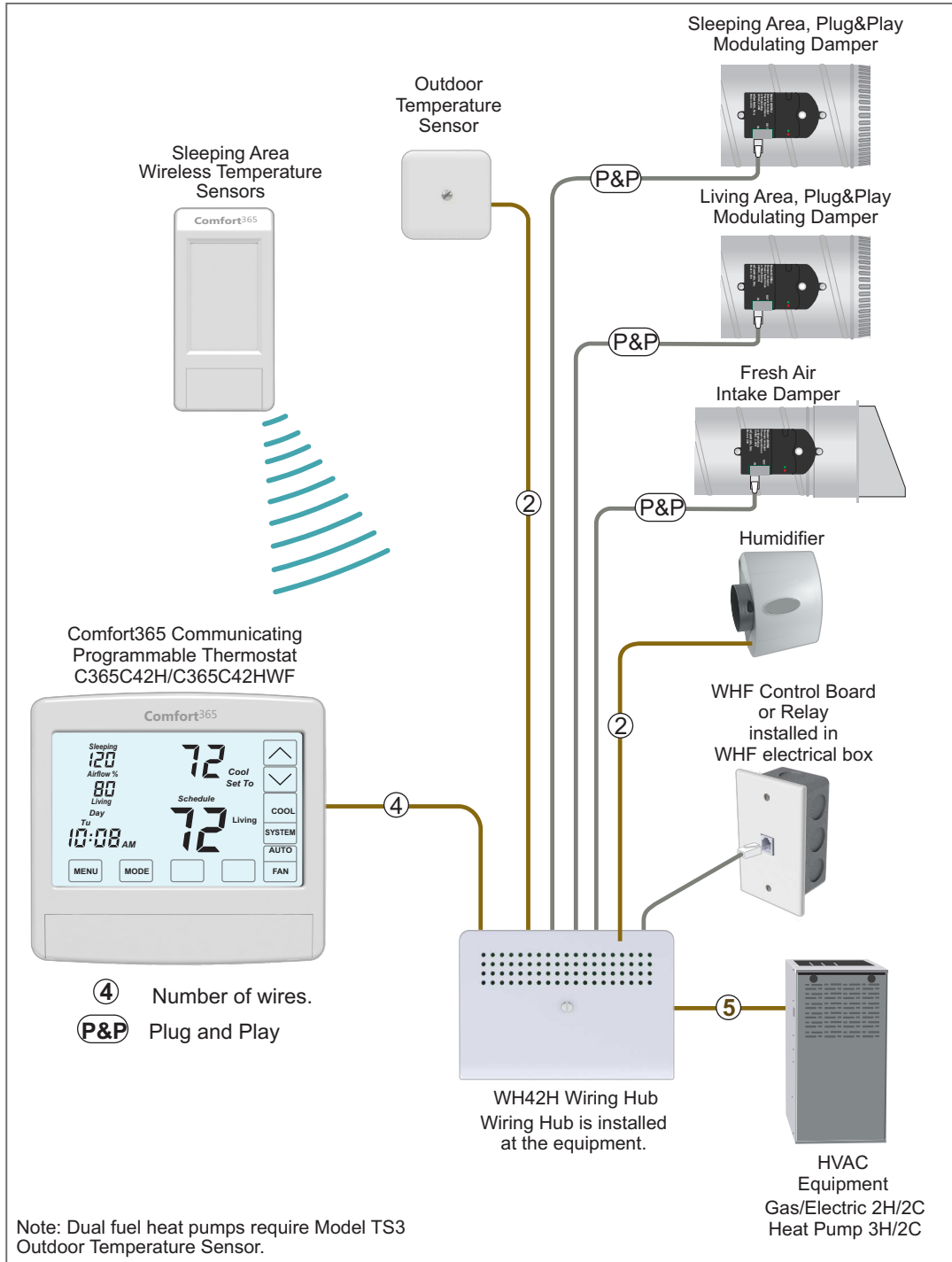

Comfort365 Thermostats

Model C365C42H
Model C365C42HWF
With WiFi

Temperature Sensors

Model TS5WL
For single or dual sleeping area sensor installations

Model TS3
Outdoor temperature sensor

Wiring Hub

Model WH42H
For multi-stage G/E or HP

Airflow Dampers

Model R80CJ-XX
Plug&Play
Modulating Damper
XX is 6 to 20-inch diameter

Fresh Air Damper

Model R80ZJ-XX
Plug&Play
Open/Close Damper
XX is 6 to 20-inch diameter

WHF Control Board

Model FC2J
Plug&Play
Controls 1 or 2-Speed PSC
or PWM control of ECM

5-Year Warranty

All products have a 5-year warranty, limited to the repair or replacement of the product due to defective material or workmanship.

eControls

26072 Merit Circle #110, Laguna Hills, CA 92653
949-916-0945, www.eControlsUSA.com